



Goose Marsh Community

The Shorebreak Floor Plan

Live at the beach without ever feeling like you've left the shoreline. The Shorebreak offers 2,590 square feet of coastal living designed for people who want their home to feel like a retreat. Three bedrooms and two full baths are standard on the first floor, with a second-floor loft and extra bedroom. Inside, the kitchen and dining area feel bright and welcoming, with sliding doors that open to a wide back porch made for cookouts, quiet mornings, or anything in between. The gourmet kitchen island, complete with a double sink and plenty of counterspace, gives you a great setup for prepping, entertaining, or simply enjoying everyday life. Drop your bags in the convenient entry area and head to the spacious owner's suite, where you'll find a tray ceiling and a large walk-in closet. The Shorebreak is made for slowing down, recharging, and living the easygoing beach lifestyle. Its open layout and thoughtful design make it a natural fit for anyone looking for a new home in Bolivia, North...

\$439,900



4 Bedrooms



3.0 Bathrooms



2,590 Sq.Ft.



2 Stories



2 Car Garage

CONTACT US 757-550-2617

WWW.CESHOMES.COM



Chesapeake Homes continuously improves home designs and reserves the right to modify home features and specifications without notice or obligation. Square footage and measurements are approximate. Renderings of elevations are artist's concepts. Floor plans vary per elevation. Chesapeake Homes standard features vary by home design and location, please refer to the included features sheet for the community to define specifications. This brochure is for illustrative purposes and not part of the legal contract. Please ask Sales Associate for complete details. © 2025 Chesapeake Homes. Current information as 25th December 2025

FIRST FLOOR



CONTACT US 757-550-2617

WWW.CESHOMES.COM



SECOND FLOOR

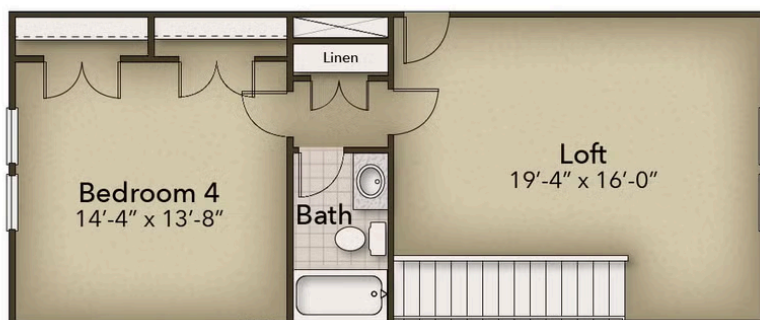

CONTACT US 757-550-2617

WWW.CHESHOMES.COM



Chesapeake Homes continuously improves home designs and reserves the right to modify home features and specifications without notice or obligation. Square footage and measurements are approximate. Renderings of elevations are artist's concepts. Floor plans vary per elevation. Chesapeake Homes standard features vary by home design and location, please refer to the included features sheet for the community to define specifications. This brochure is for illustrative purposes and not part of the legal contract. Please ask Sales Associate for complete details. © 2025 Chesapeake Homes. Current information as 25th December 2025