



Highgate Community

The Mandolin Floor Plan

Welcome to the Mandolin, a first-floor owner's suite model that is home to both luxury and everyday conveniences. With 2,267 square feet of living space, this model features four bedrooms, three bathrooms, and plenty of highly sought-after options. From a picture-perfect covered full front porch, walk through the foyer and past two bedrooms with large closets and one full bathroom. Easily free your hands or unload your car into your drop zone area just off the garage. Beyond the foyer, find an enormous and open kitchen, great room, and dining area, which make for the ultimate space to entertain guests or host family gatherings. Enjoy the rear-covered porch off the dining area to enjoy morning sunrises or evening sunsets in the ...

\$499,900



4 Bedrooms



3.0 Bathrooms



2,267 Sq.Ft.



2 Stories



2 Car Garage

CONTACT US 757-550-2617

WWW.CESHOMES.COM





CONTACT US 757-550-2617

WWW.CESHOMES.COM



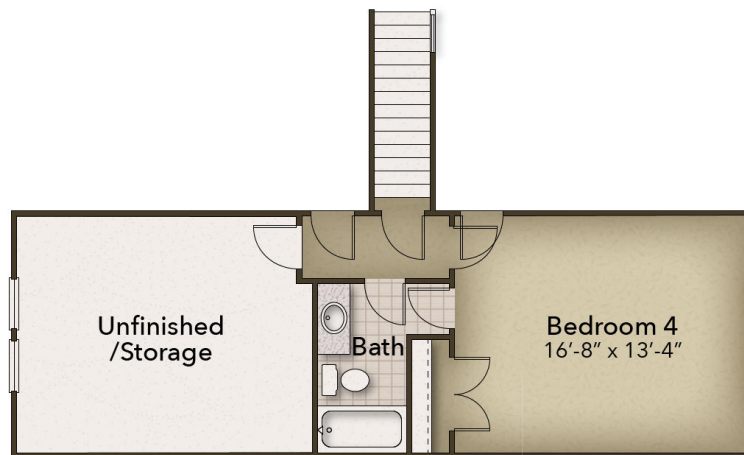

CONTACT US 757-550-2617

WWW.CESHOMES.COM

