



## Belmont Park at Albemarle Community

### The Boardwalk Floor Plan

Stroll into the Boardwalk with nearly 2,500 square feet of first-floor coastal-inspired features. Upon entering from a large covered front porch, discover a prominent foyer leading to a spacious main living area. Two bedrooms with large closets and a full bath are located on the left with an open dining area with coffered ceilings just ahead. Leading into an intimate great room area with an electric fireplace to create a cozy aesthetic. The kitchen offers a large island which offers additional seating and a surplus of counter space for large dinner parties or cooking large meals. Enjoy smaller meals tucked away in your breakfast area looking out onto the beautiful view of your backyard. From the great room, breeze through the back door onto a large covered porch. The Boardwalk's Owner's Suite offers an enormous walk-in closet accompanied by a beautiful Owner's Bath. The second floor adds a spacious loft area and a large storage area that can be used any way your heart desires! Call the Boardwalk home today! \*\*Please call our Online Sales Consultants at 757-550-2617 to learn more!

**\$476,900**



**3 Bedrooms**



**2.0 Bathrooms**



**2,465 Sq.Ft.**



**2 Stories**



**2 Car Garage**

**CONTACT US 757-550-2617**

**WWW.CESHOMES.COM**



## FIRST FLOOR



CONTACT US 757-550-2617

WWW.CHESHOMES.COM



## SECOND FLOOR

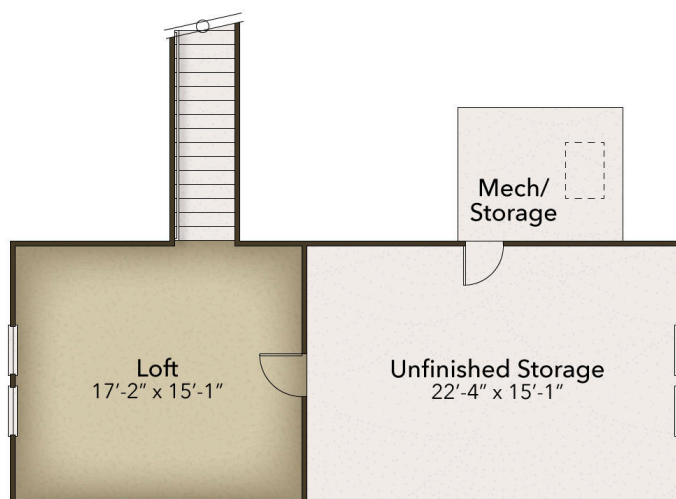

CONTACT US 757-550-2617

WWW.CESHOMES.COM



Chesapeake Homes continuously improves home designs and reserves the right to modify home features and specifications without notice or obligation. Square footage and measurements are approximate. Renderings of elevations are artist's concepts. Floor plans vary per elevation. Chesapeake Homes standard features vary by home design and location, please refer to the included features sheet for the community to define specifications. This brochure is for illustrative purposes and not part of the legal contract. Please ask Sales Associate for complete details. © 2025 Chesapeake Homes. Current information as 14th August 2025