



Terrapin Community The Shorebreak Floor Plan

\$509,900

Open-concept living isn't just a concept with The Shorebreak! Every foot of the over 2,000 square feet is used to enhance your lifestyle, while also giving you the joy of the great outdoors. A beautiful island separates the kitchen from the open casual dining room and great room. This Shorebreak model offers 3 bedrooms and 3 bathrooms with a downstairs study as well as an upstairs loft. The roomy Owner's Suite is already fitted with tray ceilings, a double sink vanity in the bathroom, and a long walk-in closet with options for a deluxe bathroom that includes having both a tub and a standing shower. If you are not sold on the Shorebreak yet, we can't let you go before you hear about the vast covered back porch connected to a patio. Perfect for sitting back and enjoying an evening sunset or hosting a party with your new neighbors. This versatile plan is a great option for any family who loves the time they spend inside as much as they do outside. *PHOTOS OF SIMILAR HOME*



3 Bedrooms



3.0 Bathrooms



2,604 Sq.Ft.



2 Stories



2 Car Garage

CONTACT US 757-550-2617

WWW.CESHOMES.COM



FIRST FLOOR



CONTACT US 757-550-2617

WWW.CESHOMES.COM



SECOND FLOOR

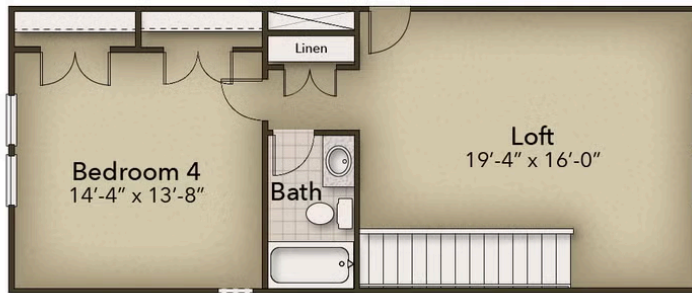

CONTACT US 757-550-2617

WWW.CESHOMES.COM

