



Bridgewater - Shorehaven Village Community

The Boardwalk Floor Plan

The Boardwalk is a 3 bed, 3 bath, two-story home with 2,189 square feet of well-designed living space. Enter from the covered front porch into a foyer that leads to a spacious drop zone. Two bedrooms with large closets and a full bath are located on the first floor, along with an open dining area. The main living space features a great room, kitchen, and breakfast area that flow together seamlessly. The kitchen includes a large island with ample seating and counter space, ideal for everyday living and entertaining. Sliding glass doors lead to a covered rear porch, extending the living space outdoors. The owner's suite is located on the main level and features a large walk-in closet and private bath. The second floor includes an additional bedroom, full bath, and a loft area, providing flexible space for guests or additional living. This home offers a functional two-story layout with open living and added versatility. *PHOTOS OF SIMILAR HOME*

\$461,900



3 Bedrooms



3.0 Bathrooms



2,189 Sq.Ft.



2 Stories



2 Car Garage



FIRST FLOOR



CONTACT US 757-550-2617

WWW.CESHOMES.COM



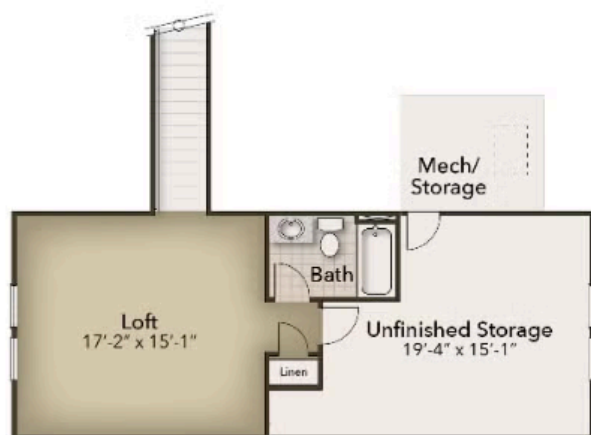

CONTACT US 757-550-2617

WWW.CESHOMES.COM

