



The Willows Community

The Boardwalk Floor Plan

Welcome to the Boardwalk, a stunning coastal-inspired home with over 2,100 square feet of features, not to mention a large homesite size of over 1/4 acre! As you enter from the spacious covered front porch, you'll be greeted by a foyer with an optional tray ceiling and a convenient drop zone area. On the left, you'll find two bedrooms with large closets and a full bath. Ahead, an open dining area awaits. Choose to add an intricate coffer ceiling or beautiful barn doors. The great room can be transformed into an intimate space with a tray ceiling or gas fireplace. The kitchen boasts a large gourmet island, perfect for entertaining, and a breakfast area with a view of the backyard. Step through sliding glass doors onto the covered porch, which can be customized with an outdoor fireplace. The Owner's suite in the Boardwalk is a retreat with an enormous walk-in closet and a stunning owner bath. Customize your bath with options for a deluxe seated shower or deep soaking tub. An optional second-floor plan adds a bedroom, full bath, walk-in closet, linen closet, and a spacious loft area. Use ...

\$439,900



4 Bedrooms



3.0 Bathrooms



2,815 Sq.Ft.



2 Stories



2 Car Garage

CONTACT US 757-550-2617

WWW.CESHOMES.COM





CONTACT US 757-550-2617

WWW.CESHOMES.COM



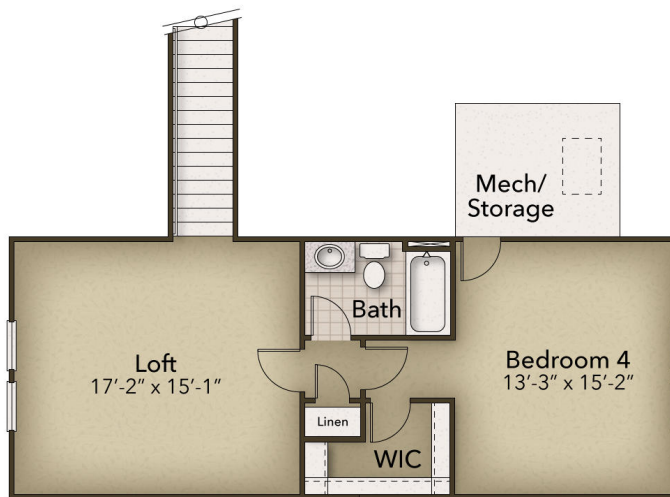

CONTACT US 757-550-2617

WWW.CESHOMES.COM

