



Traditions at Carolina Forest Community

The Longboard Floor Plan

The Longboard is a beautifully designed one-story home offering 2,030 square feet of luxury living. With three bedrooms, two bathrooms, and a flowing open-concept layout, it's perfect for relaxing or entertaining. Enter through the covered front porch, rear porch, or two-car garage and enjoy seamless transitions between the airy kitchen, dining, and great room. Two spacious bedrooms with walk-in closets and a full bath are thoughtfully placed for privacy. Beyond the great room, the impressive Owner's Suite features a large bedroom, expansive walk-in closet, and a spa-like bath with options for a soaking tub or seated shower. The Longboard is the perfect place to call home.* Some photo of similar homes.

\$510,900



3 Bedrooms



2.0 Bathrooms



2,589 Sq.Ft.



2 Stories



2 Car Garage

CONTACT US 757-550-2617

WWW.CESHOMES.COM



Chesapeake Homes continuously improves home designs and reserves the right to modify home features and specifications without notice or obligation. Square footage and measurements are approximate. Renderings of elevations are artist's concepts. Floor plans vary per elevation. Chesapeake Homes standard features vary by home design and location. Please refer to the included features sheet for the community to define specifications. This brochure is for illustrative purposes and not part of the legal contract. Please ask



CONTACT US 757-550-2617

WWW.CHESHOMES.COM



Chesapeake Homes continuously improves home designs and reserves the right to modify home features and specifications without notice or obligation. Square footage and measurements are approximate. Renderings of elevations are artist's concepts. Floor plans vary per elevation. Chesapeake Homes standard features vary by home design and location, please refer to the included features sheet for the community to define specifications. This brochure is for illustrative purposes and not part of the legal contract. Please ask Sales Associate for complete details. © 2025 Chesapeake Homes. Current information as 20th May 2025

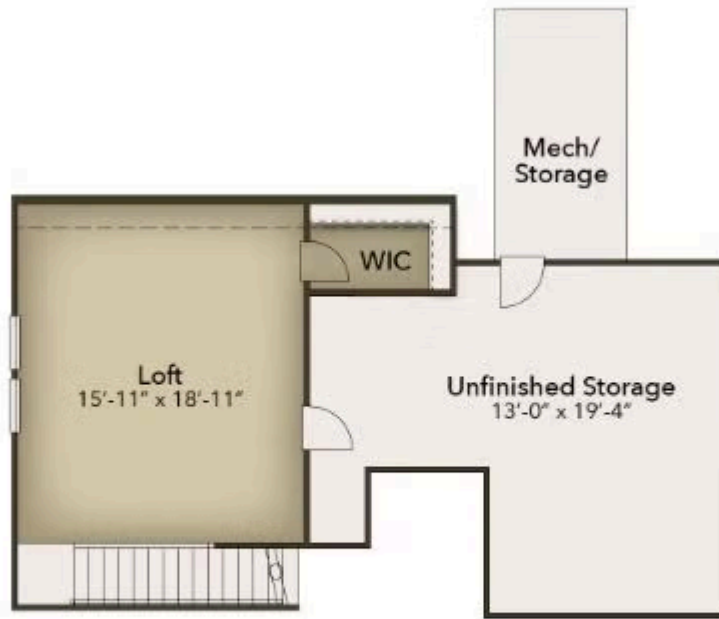

CONTACT US 757-550-2617

WWW.CESHOMES.COM



Chesapeake Homes continuously improves home designs and reserves the right to modify home features and specifications without notice or obligation. Square footage and measurements are approximate. Renderings of elevations are artist's concepts. Floor plans vary per elevation. Chesapeake Homes standard features vary by home design and location, please refer to the included features sheet for the community to define specifications. This brochure is for illustrative purposes and not part of the legal contract. Please ask Sales Associate for complete details. © 2025 Chesapeake Homes. Current information as 20th May 2025