



Waterbridge Community

The Newberry Floor Plan

The Newberry is the perfect balance between outdoor living space and a coastal-inspired interior, encouraging you to slip off your Flip Flops and relax. This home has three bedrooms, two bathrooms, and a second floor with a loft. Step in from the Newberry's covered front porch to find an open kitchen, dining, and great room area. Breeze through sliding glass doors onto a 179 square foot covered porch, ideal for warm summer evenings or afternoon get-togethers. Gather in the spacious gourmet kitchen or in the great room with a beautiful tray ceiling. Whether you're looking for an abundance of counter space, added seating, or a more intimate gathering area, this home has a solution. Through the foyer, you'll find a drop zone and laundry area and a bench for seating while you unload beach accessories or sand-filled clothes. Drop-off beach chairs in the convenient storage space just inside the garage, as well. Beyond the open living space, find a stunning master suite complete with a tray ceiling, enormous walk-in closet, double vanity, and a seated shower. Go ahead, kick your feet up, sit back, and relax among the day-to-day comforts and ...



3 Bedrooms



2.0 Bathrooms



1,918 Sq.Ft.



1 Stories



2 Car Garage

CONTACT US 757-550-2617

WWW.CHESHOMES.COM



FIRST FLOOR



CONTACT US 757-550-2617

WWW.CHESHOMES.COM



Chesapeake Homes continuously improves home designs and reserves the right to modify home features and specifications without notice or obligation. Square footage and measurements are approximate. Renderings of elevations are artist's concepts. Floor plans vary per elevation. Chesapeake Homes standard features vary by home design and location, please refer to the included features sheet for the community to define specifications. This brochure is for illustrative purposes and not part of the legal contract. Please ask Sales Associate for complete details. © 2025 Chesapeake Homes. Current information as 18th September 2025

SECOND FLOOR

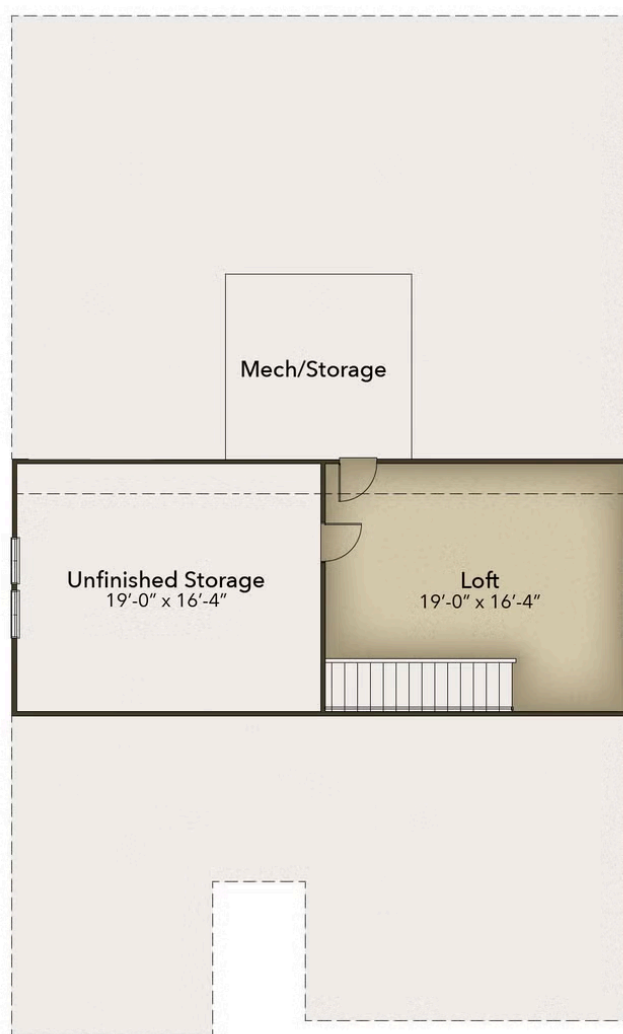

CONTACT US 757-550-2617

WWW.CHESHOMES.COM

